



2-Person Job



Allen Wrench  
Provided



Adjustable Wrench  
Not provided

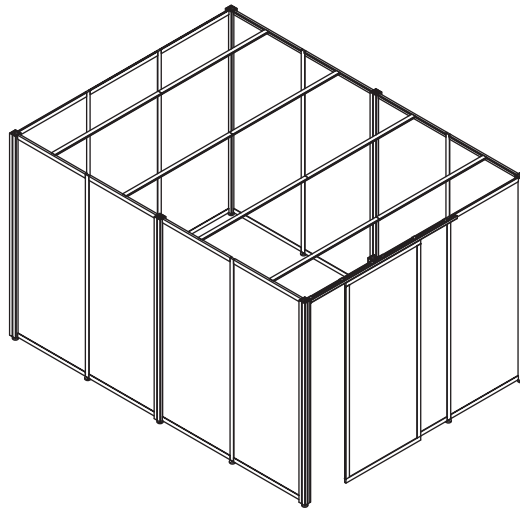

### Note:

While these instructions show a 12' x 16' Room with style 1 walls and an attached sliding door, the steps will apply for all Rooms. Please reference your specific project notes for order specific information.

## BEFORE YOU BUILD YOUR ROOM

Best practices to follow

- Mark off your space. Referencing your project notes, ensure you have the proper space to build your Room.
- Understand your panel layout. While panels can be moved after the Room is assembled, some deconstruction is required.
- Understand your cross-beam locations. Supporting cross-beams must run perpendicular to L channel extrusion. For example:



L Channel

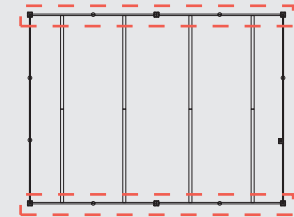

## ASSEMBLING THE FIRST WALL

Steps 1 - 3 on page 2

- 1** Starting in a corner. Person-1 holds the square 3" x 3" vertical post with attached leveling foot (approx. 90" H) upright while Person-2 locks the first horizontal extrusion.
- 2** Person-2 will connect the adjoining vertical extrusion (approx. 90"H to match 3" x 3" vertical post) and locks into the bottom horizontal extrusion. Check the level of the horizontal extrusion prior to moving on to inserting panels. Extrusion should be level with bottom of 3" x 3" vertical post.
- 3** Person-1 should now hold both the vertical extrusion and the vertical while Person-2 inserts panels from above. The number of panels and horizontal extrusions will be depended on the wall style selected by the customer. See page 2 for more details.

## BUILDING OUT THE SIDES AND THE CROSS-BEAMS

Steps 4 - 11 on page 2 and 3

- 4** While securely holding the previously built wall, steps 1 - 3 should be repeated on a perpendicular wall. This corner will provide stability that allows you to create longer runs.
- 5 - 8** Once a corner is created, continue building the sides of the Room. Note the "Before You Build Your Room" section on using the proper top extrusion piece based on the location of your cross-beams. Additionally, any run of 4 or more walls will need to be split by a square 3" x 3" vertical post.
- 9 - 11** Starting at one of the outside edges of the Room, begin locking the overhead cross-beams into place. For maximum stability, these cross-beams should be placed halfway between each wall width.

# LOFTWALL

# ROOMS

## ASSEMBLY INSTRUCTIONS

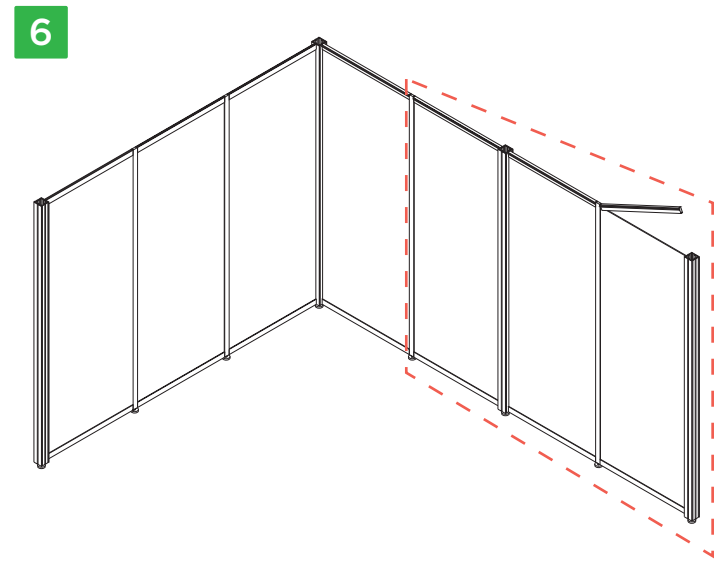
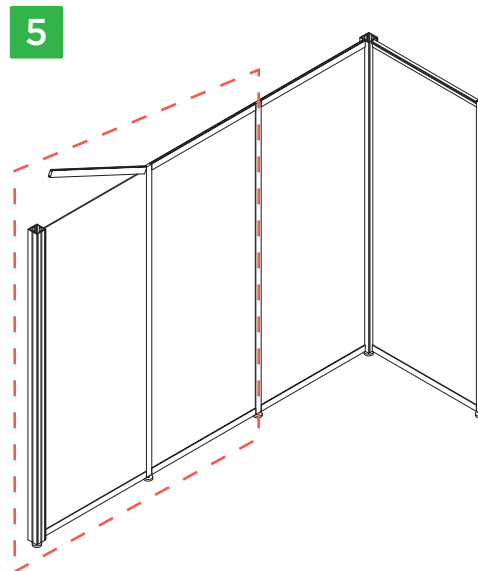
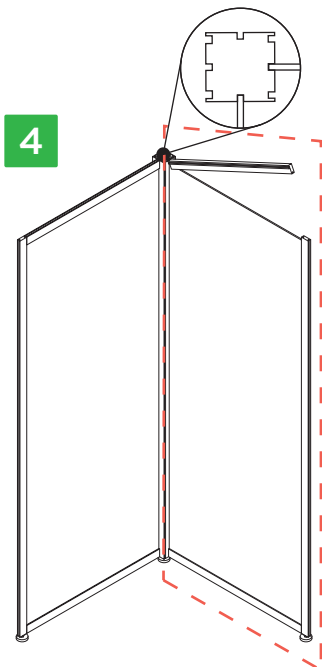
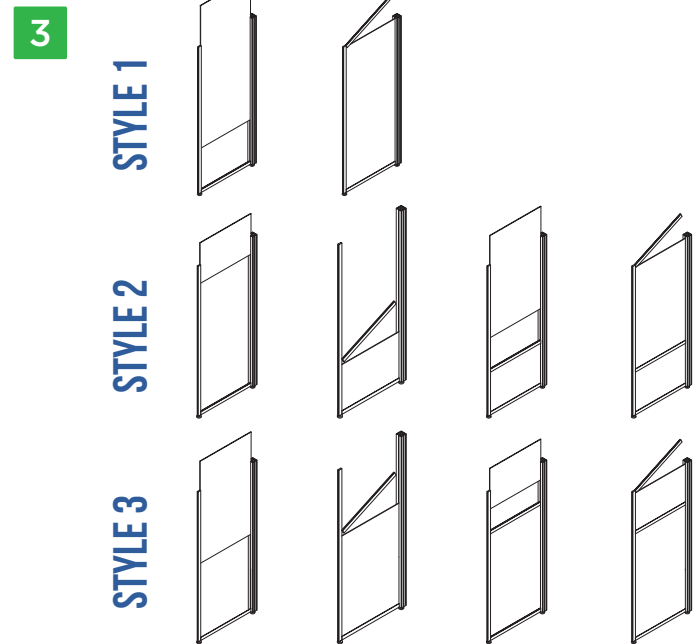
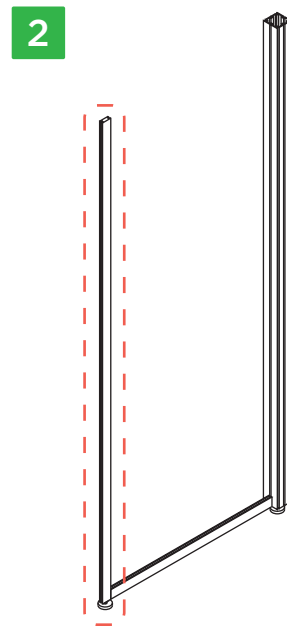
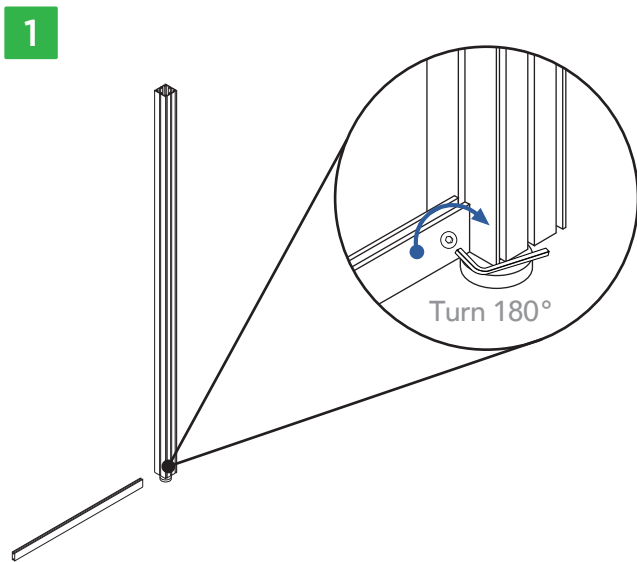

7

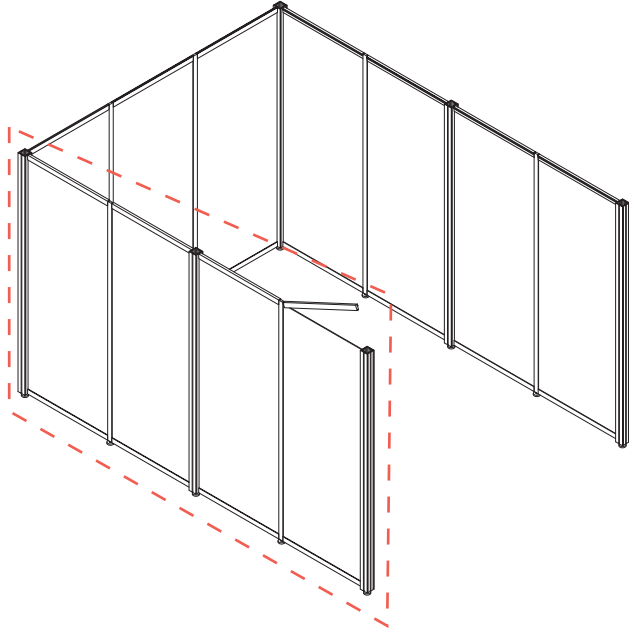

8

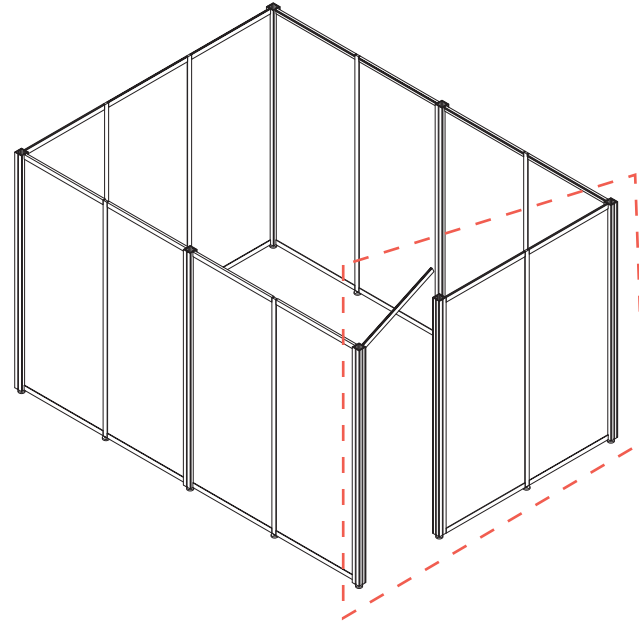

9

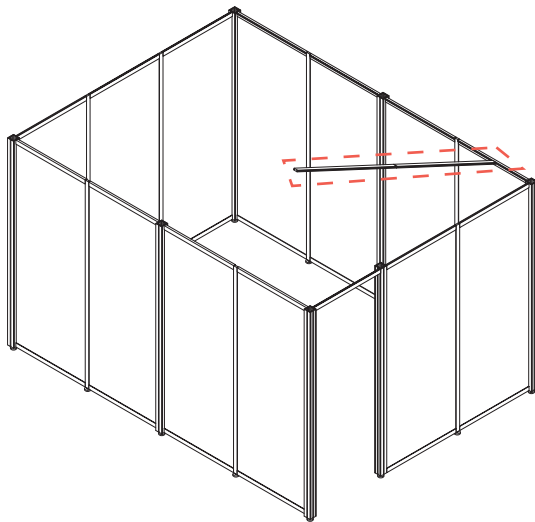

10

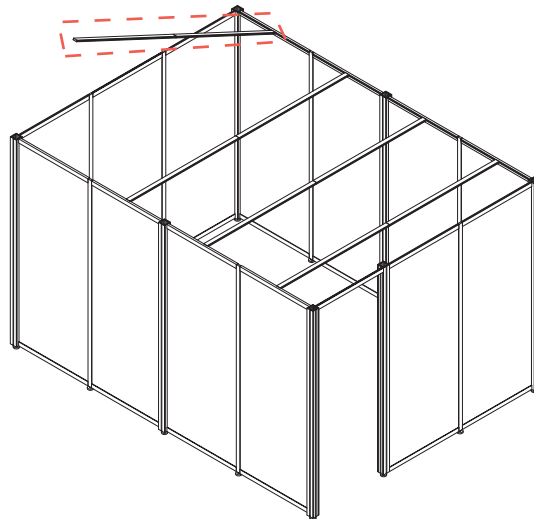

11

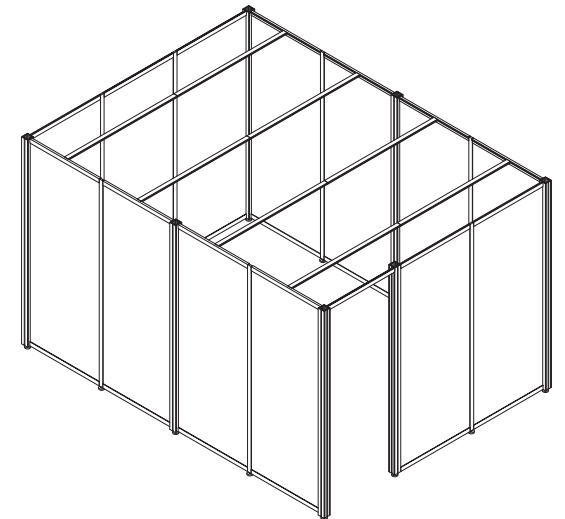



2-Person Job



Allen Wrench  
Provided



Screw Driver  
Provided



Track Trolleys



Trolley Stoppers



Celebratory Drinks  
Not provided, but encouraged.

Email pictures of your assembled Room to [orders@loftwall.com](mailto:orders@loftwall.com) and we'll buy your next drink!

12

To attach a door to your Room, lock the extrusion track above the desired door location. Extrusion track must be locked in between two 3" x 3" posts on the exterior channel. See diagram below.

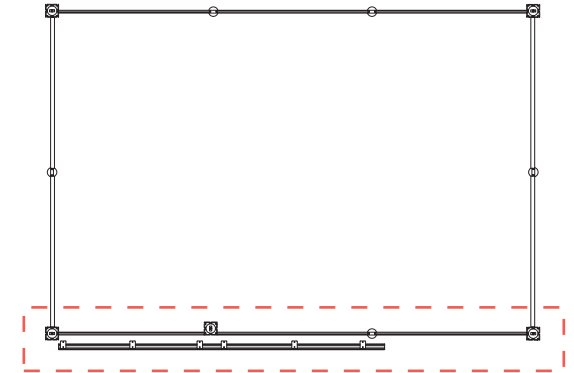
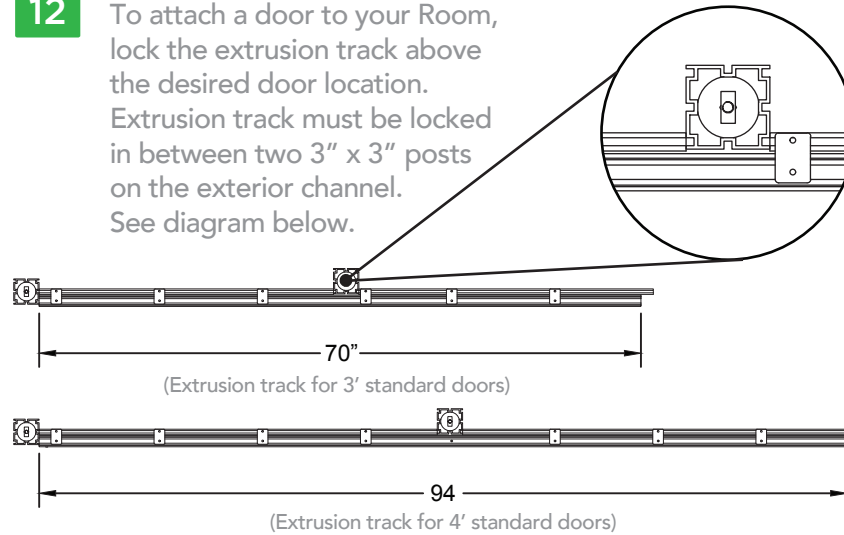

The door's extrusion track must be installed between two 3" x 3" vertical posts.

13

Begin assembling the door. Ensure the extrusion with a handle is on the exterior facing right side. Slide trolleys into the door track. Lock into place.

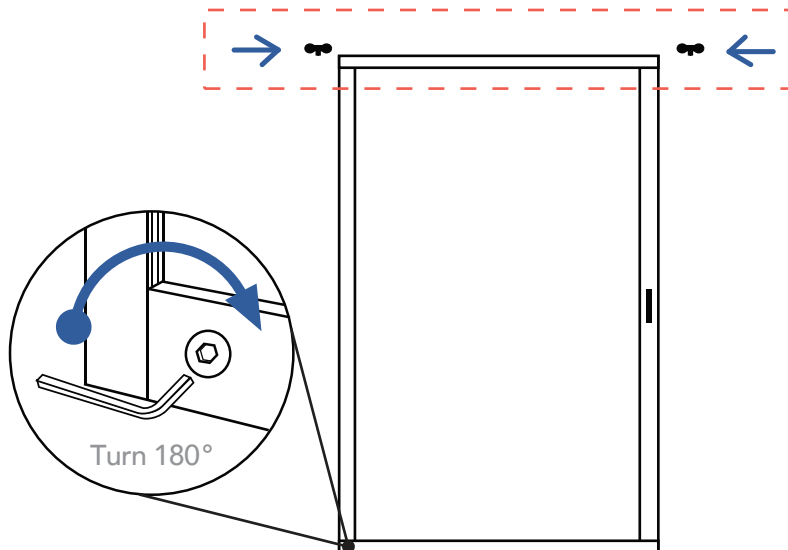

14

Add and lock in trolley stoppers into the extrusion track. Slide the door into the extrusion track.

